

PLEASE CHECK WWW.MOLEX.COM FOR LATEST PART INFORMATION

Part Number:

0622018784

Status:

Active

Overview:

Application Tooling

Description:

Backplane Module Installation Press-In Tool

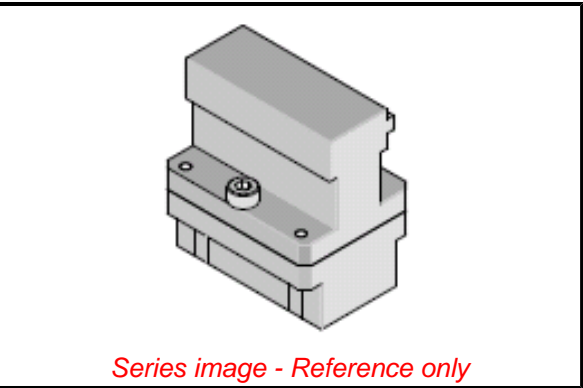

Documents:

RoHS Certificate of Compliance (PDF)

General	
Product Family	Application Tooling
Series	207123
Function	Insertion
Geographic Area	Global
Level of Automation	Semi-Automatic
More Detailed Tech Information	applicationtooling@molex.com
Overview	Application Tooling
Product Name	Impact
Tool Type	Press-Fit Insertion Tool
UPC	884982288010
Warranty Disclaimer	CAUTION: Molex tooling crimp specifications are valid only when used with Molex terminals and tooling manufactured by Molex and sold by Molex or authorized distributors ("Molex Tooling"). When using tooling other than Molex Tooling with Molex specific connector systems listed in our ATS documents, the Molex tooling qualification does not apply and the responsibility for full qualification of the connector system is that of the customer. Molex accepts no liability for connector performance or tooling support where tooling other than Molex Tooling is used or where Molex Tooling is modified.

Material Info	
Reference - Drawing Numbers	
Application Tooling Documents	ATS-622018784, TM-622018799

EU ELV Not Relevant	
EU RoHS Not Reviewed REACH SVHC Not Contained Per -ED/01/2018 (15 January 2018) Halogen-Free Status Not Relevant For more information, please visit Contact US	China RoHS
China ROHS	Not Relevant
ELV	Not Relevant
RoHS Phthalates	Not Contained

Search Parts in this Series	
207123 Series	
Use With	
Impact Backplane Signal Module Assembly, (4-Pair by 18 Column 85 Ohm Assemblies) 170332	
Application Tooling Description	FAQ Product #
Impact BP 4x18 85-ohm GL/W Sn Custom	1703320003

PLEASE CHECK WWW.MOLEX.COM FOR LATEST PART INFORMATION